

SE Roller Cover.

Yet another first from Oz Roll™ the “SE Roller Cover” is set to become an essential item for all side entry in reveal shutters. It is one of those items that make you wonder why it wasn't available years ago, so simple yet so practical.

The “SE Roller Cover” has been designed specifically to fit on both the SQ and Eliso™ RD range of boxing materials. However it will also suit most other types on the market. It has been designed to completely cover the very successful “SE Roller” introduced by OZ Roll™ early in 2000, as well as the internal roller on the RD boxing system.

The cover is designed to fit either left or right hand control sides, and it simply clips onto the back of the box section. This makes it ideal for retro fitting as there is no need to remove the shutter to fit the cover in position.

The part has a maximum cover from the back of the box of 60mm, which should satisfy most standard installations. Made from a flexible polypropylene material the cover is very easily cut to size using tin snips or even a good quality pair of scissors. There are a series of guidelines on the inside of the cover that will assist when cutting it to suit the various installation methods.

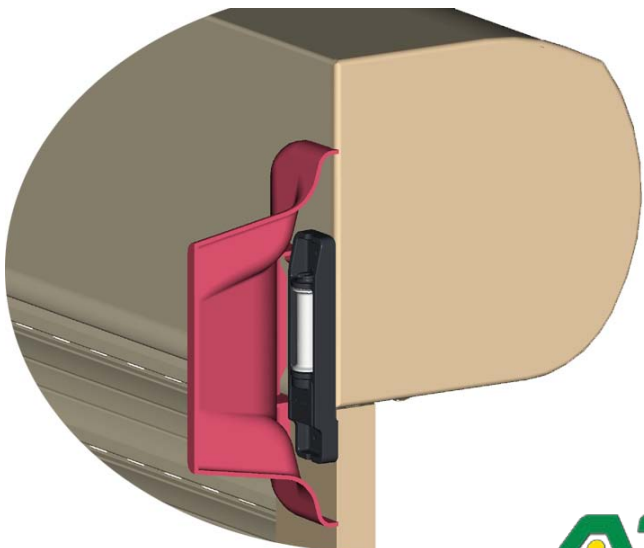
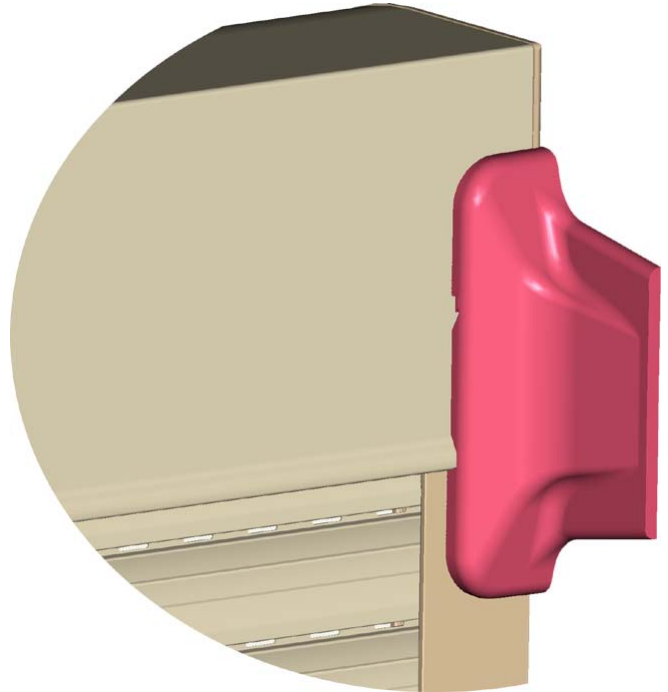

The “SE Roller Cover” is available in four of the standard boxing colours of White, Brown, Cream and Sand. It is in stock now and ready for immediate delivery in convenient bags of 10.

The Part Numbers are as follows:

13.274.401	SE Roller Cover – White
13.274.403	SE Roller Cover – Brown
13.274.408	SE Roller Cover – Cream
13.274.411	SE Roller Cover - Sand