



# E-PORT INSTALLATION INSTRUCTIONS

**OZRoll Pty Ltd**  
174 Cavan Road  
DRY CREEK SA 5094  
AUSTRALIA.

E sales@ozroll.com.au  
W www.ozroll.com.au

The OZRoll Logo is a registered trademark of OZRoll Pty Ltd.

Copyright © 2008. OZRoll Pty Ltd. All Rights Reserved.

No part of this publication may be reproduced, stored in a retrieval system, or transmitted, in any form or by any means, electronic, mechanical, photocopy, recording, or otherwise, without the prior written permission of OZRoll Pty Ltd.

Due to continued research & development changes may be made to the information in this publication without obligation to notify any person of such revision or changes.

INSTALLATION INSTRUCTIONS E-PORT  
Version 02 - APRIL 2009.  
PART NUMBER 15.920.253

## SPECIFICATIONS.



### E-Port Wall Plate

Size: H 83 mm  
W 83 mm  
D 36 mm

Weight: 40g

## 1. INTRODUCTION

Position the E-Port Wall Plate 1300mm above the floor on the same side as the drive unit for the window shutter.

It may be desirable to be near a power point for charging purposes. If a charger is to be connected allow 35mm of extra room below the E-Port installation.

One E-Port Controller per Wall Plate can be used or the E-Port Controller can be shared amongst multiple Wall Plates.

## 2. INSTALLATION

Insert and turn a large, flat bladed screwdriver in the slot on the top of the wall plate. This will separate the Wallplate Cover from the Housing. The holes will now be visible for the mounting screws.

The mounting method will depend on the construction of the wall. Refer to the details below.

### Plasterboard Walls

Plasterboard walls will require the use of a C-Clip Bracket (available in E-Flush Mount Kit 15.592.000).

Use the template overleaf to mark the centres of the large central hole and two small fixing holes. This bracket is suited to fitment in a 50 to 55 mm central hole.

The diameter of the fixing holes should be 10mm. Fit the C-Clip Bracket and use the tab to hold it in position, as shown.

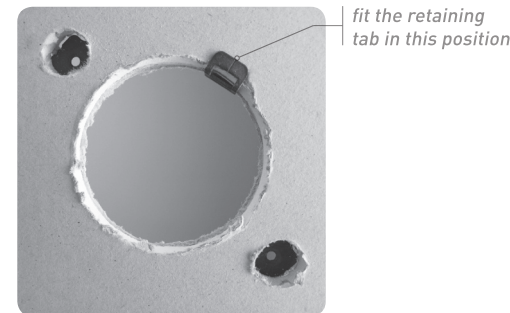

### Solid Walls

Use the template overleaf to mark the centres of the holes.

It is recommended that a 16-20mm hole be made in the centre to make it easier to feed through the wiring loom from the motor.

Drill appropriately sized holes and use two wall plugs to mount the Wall Plate.

## 3. WIRING THE WALL PLATE

### Left Hand Installation

A **left-hand** installation is defined as having the drive motor on the left-hand side of the shutter when viewed from inside the house. For these installations connect the **RED** wire from the drive motor to the Wall Plate Terminal that is marked **M2**. Connect the **BLACK** wire from the drive motor to the Wall Plate Terminal that is marked **M1**.

motor terminal 1 (M1) | motor terminal 2 (M2)

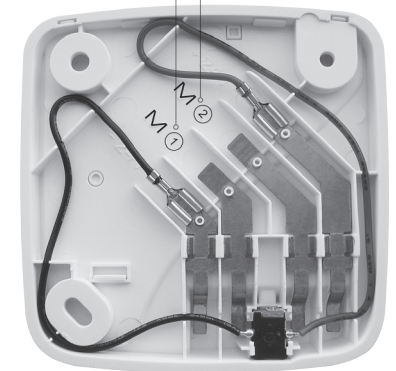

### Right Hand Installation

A **right-hand** installation is defined as having the drive motor on the right-hand side of the shutter when viewed from inside the house. For these installations connect the **RED** wire from the drive motor to the Wall Plate Terminal that is marked **M1**. Connect the **BLACK** wire from the drive motor to the Wall Plate Terminal that is marked **M2**.

### Completing the Installation

Once the wiring of the Wall Plate is complete it can be mounted using two screws.

Check the installation by inserting an E-Port Controller and operating the shutter.

Once satisfied that the installation is complete refit the Wallplate Cover. Do this by firstly positioning the bottom right corner of the cover, then clipping the top into place.

### 3. INSTALLATION TEMPLATE

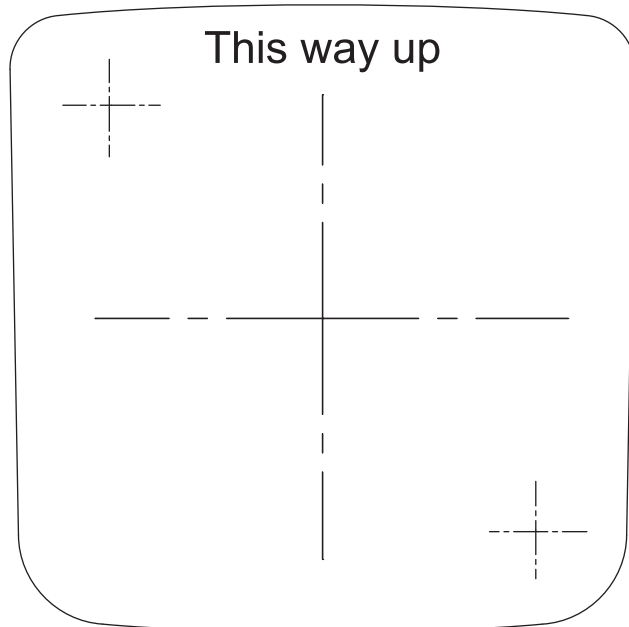

### 4. TROUBLESHOOTING

#### SYMPTOM

#### REMEDY

**The Controller will not operate the shutter.**

- Ensure the E-Port Controller is properly seated in the Wall Plate. It should be flush against the bottom of the wallplate, with no gap.
- If the CHARGE LED on the Controller is flashing the battery needs charging.
- If the TOP & CHARGE LEDs on the Controller are alternately flashing then the Controller is in lockout mode. Wait several minutes prior to further use.
- Ensure that all four spade terminals have been firmly pushed on to the Wall Plate terminals.

**The Controller will not charge (the CHARGE LED does not illuminate).**

#### For Plug In Charger installations

- Ensure the charger is plugged into a power point and the power is switched on.
- Ensure that the charger is plugged into the Wallplate, or directly into the Controller.
- Ensure that the CHARGE LED lights for 5 seconds when the charger is plugged in (this may take a few seconds to occur).
- If the battery is fully charged it will not accept any more charge. However the CHARGE LED will still glow for 5 seconds to indicate that power is available and the battery will charge when necessary.

#### For In Wall Charger installations

- For installations that use an In Wall Charger the charger is permanently attached to the rear of the wall plate. The CHARGE LED should illuminate for 5 seconds when the Controller is placed in the Wallplate (this may take a few seconds to occur). If the battery is fully charged it will not accept any more charge. However the CHARGE LED will still glow for 5 seconds to indicate that power is available and the battery will charge when necessary.

**The shutter operates in the reverse direction to the buttons.**

- Swap the wires (spade terminals) that are connected to the terminals marked **M1** and **M2** on the back of the wallplate.

### 5. PRODUCT WARRANTY & CUSTOMER SERVICE

#### Customer Care.

There are no user-serviceable parts in the E-Port Controller. Opening any components will void your warranty. Do not dispose of in fire. Contact your retail agent should service be required.

**Product Warranty** - OZRoll guarantees the E-Port Controller components for 12 months from date of purchase against any defect in materials or workmanship under conditions of normal use and service, and subject to proof of the date of purchase being provided.

**Warranty Service Conditions** - OZRoll expressly limits its liability with respect to its products to the person who purchases the product from an OZRoll authorised reseller. OZRoll expressly limits its liability with respect to its products to: [ in the absolute discretion of OZRoll ]

1. The cost of having the goods repaired
2. The cost of replacing the goods: or
3. The cost of obtaining equivalent goods.

In the event of the goods requiring service under warranty, the owner is responsible for the prepaid cost of appropriate transportation to the authorized service organization. Whilst in transit the goods are at the owner's risk.

Should the goods be found to be in sound working order by the authorized service organization the owner may be charged a service fee.

The goods will not be eligible for service under this warranty if:

1. Proof of date of purchase cannot be provided.
2. The goods are not branded E-Series by OZRoll Pty Ltd.
3. The goods have been supplied to or used by a person other than the purchaser.
4. The defect was caused by an accident, misuse, abuse, improper installation or operation, lack of reasonable care and maintenance, unauthorized modification, loss of parts, tampering or attempted repair by a person not authorized by OZRoll.

OZRoll shall not be liable for any loss or damage arising from the purchase, use or inability to use this product or for any special, indirect, incidental or consequential damages. No other warranties, express or implied, are made. Nothing in this warranty excludes, restricts or modifies any condition, warranty, right or liability implied or protected by law where to do so would render this warranty, or any part of it void.