

Introduction

IMPORTANT READ THIS FIRST!

Guide to the pictograms and terminology used throughout the guide

This installation guide uses pictograms to illustrate the various procedures required to install Somfy motors and control products. The information below provides a brief explanation of what the pictograms represent and the course of action required to replicate the installation procedure:

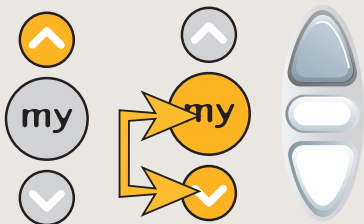

Control button operation - The yellow or grey button images along with the yellow pointing arrow require the installer to push the corresponding buttons as illustrated in the guide. Where highlighted, there may also be a requirement to hold the buttons for a set time period e.g. - **Press for 3 secs** -

This would require the installer to press and hold the relevant button(s) for up to 3 seconds.

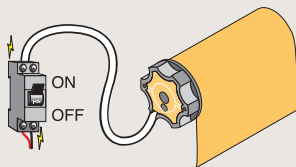

Turn the power on to the motor - Where you are instructed to, simply turn on the power and follow the instructions.



JIGGLE - The term 'jiggle' is used to describe a quick double movement from a Somfy RTS motor when it recognises a radio command and signals its response to the installer. In other words, you may signal a command to a RTS motor from a RTS controller and the end product (awning, roller shutter, blind etc.) will move briefly back & forth or up & down to confirm the command.



The word 'my' is inscribed on the Stop button of some Somfy RTS controls. This refers to the 'my' or intermediate position (IP) which is triggered by pressing the Stop or 'my' button. For this function to work, the installer must configure the intermediate position (if the function is available) according to the end user's requirements.

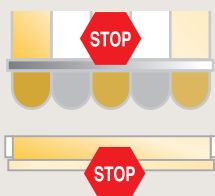

The stop icon over an illustration of an end product requires the installer to stop the end product in the position illustrated. This may be at the fully Up or Down limit positions or at a mid point to set an intermediate position. The stop command is achieved by pressing the Stop or 'my' button on a Somfy control.



Throughout the guide, the 'Somfy Tip' icon will be displayed to provide the installer with additional information. Please take the time to read this information as it could save you time and provide invaluable insight relating to the motor or control functionality you are currently working on.



COMPATIBLE WITH... Wherever you see this symbol, the listed controllers are fully compatible with the shown component.

Introduction

IMPORTANT READ THIS FIRST!

Ensuring correct operation: When UP is UP or RETRACTED and DOWN is DOWN or EXTENDED

1. Ensuring correct operation

Whenever operating Somfy equipment make certain that the control of the end product follows the below mentioned working functionalities. This will guard against unwanted or erratic behaviour that could occur due to automated commands that are carried out by the various controllers, sensors, etc.

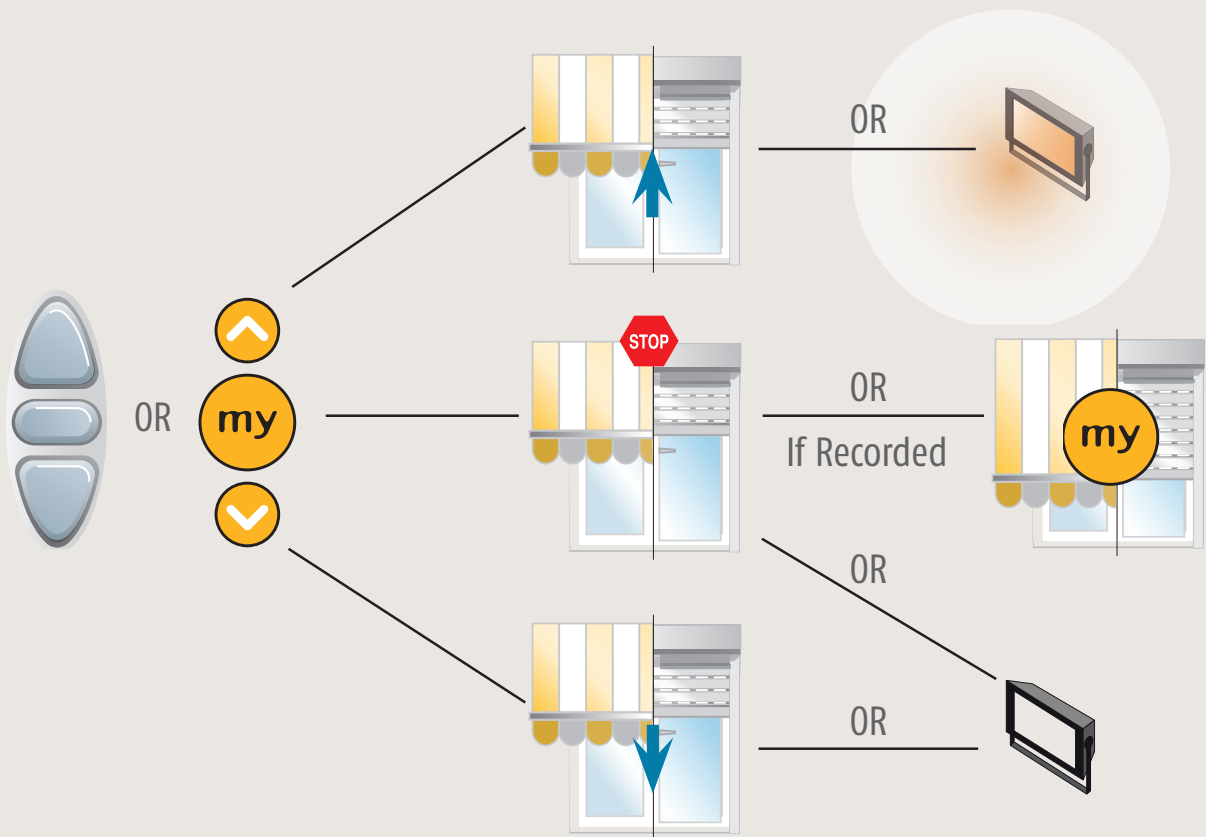

2. Explanation

When using a Somfy controller the "Up" button should always raise or retract. (Illuminate the Light if using a light receiver).

The "my" or stop button will stop the product when it's in motion. (Turn off the light if using a light receiver) or if an IP or "my" position has been set (see page 6 for description, and associated product sections for programming), pressing the "my" button again will send the product to its pre-programmed intermediate position.

The "Down" button on the remote should always lower or extend the end product. (Turn off the Light if using a light receiver). Verify your remote or controller is positioned correctly by making sure the "my" and "Somfy" labels are read the right way around or the channel LEDs (where used) are at the bottom.

Introduction

IMPORTANT READ THIS FIRST!

Program button location for RTS transmitters and receivers

Transmitter program buttons



Situo RTS range



Smooove RTS



Sunis/ThermoSunis
Indoor Wirefree

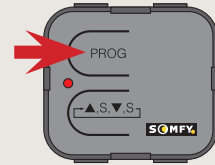

Dry Contact Transmitter

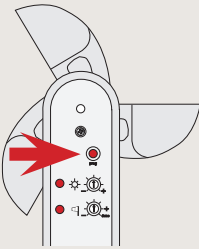

Soliris/Eolis RTS

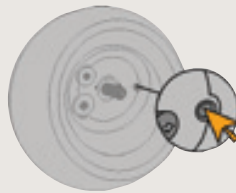

Sunis RTS

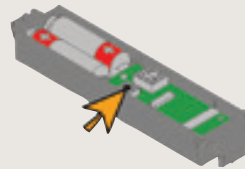

Eolis 3D RTS

Receiver program buttons

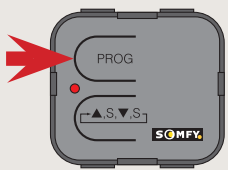

Centralis Indoor RTS



Centralis Uno RTS

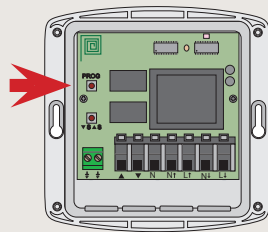

Universal Receiver RTS



Integrated Receiver

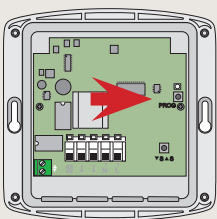

Lighting Outdoor RTS

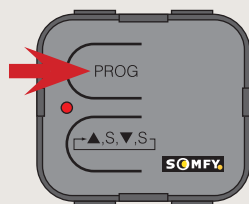

Lighting Indoor RTS



DC RTS Receiver



Power 2.5 DC RTS

Introduction

IMPORTANT READ THIS FIRST!

Universal test lead

The universal setting tool enables the 230 V Somfy radio (RTS), wired electronic control (WT) and wired mechanical motors to be commissioned, as well as motors for both wired mechanical and electronic exterior venetian blinds.

In the event of a malfunction, the universal setting tool is used to determine whether the fault comes from the power supply or the motor itself.

1. Voltage indicator (LED)
2. Up/Down Button
3. RTS connection indicator (LED)
4. RTS/WT selection button
5. Connection terminals
6. Hirschmann connector

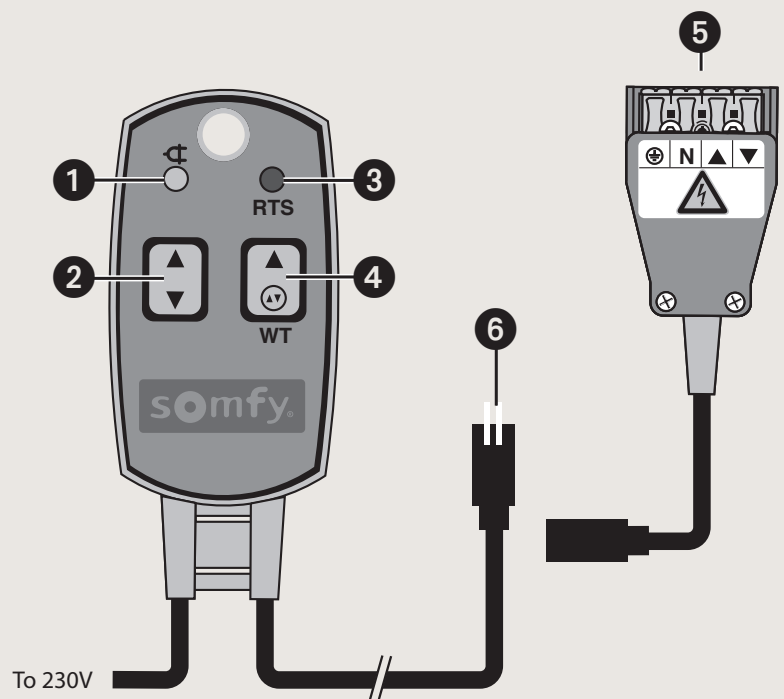

**A MUST HAVE
FOR ALL
INSTALLERS**

Contact Somfy Customer Support to order:

Part Number: 9015971

Somfy Customer Support
+61 (2) 8845 7200

Order via our webstore:
www.ShopSomfy.com.au

